



FOR STARTERS



PER MONTH
£1,500 Per Month

MAIN COURSE

A well-presented three-bedroom home located in a quiet position on the popular south of the river development of Trinity Mead. The property offers well-balanced accommodation ideal for a couple or small family.

On the ground floor, there is a welcoming entrance hall with a cloakroom, a spacious kitchen and dining room with ample storage and space for a table, a separate lounge, and a large conservatory that adds valuable extra living space and opens out to the garden. Upstairs, the main bedroom includes an en-suite shower room, while the two further bedrooms are served by a modern family bathroom.

Outside, the rear garden has been attractively landscaped and provides a pleasant space to sit out and enjoy. The property also benefits from a garage and an allocated parking space.

Trinity Mead remains a sought-after location thanks to its peaceful setting and easy access to Stratford town centre, local schools, and amenities.

Available Now!
One pet considered.



LOCATION

Please see Tenancy Information under the Lettings heading on the toolbar on our website.

KEY INGREDIENTS



Tenure



Council Tax
Band - D



EPC
Band - D



TBC



Heating system
TBC



TBC

WHY NOT TAKE
A LOOK INSIDE?
GIVE US A CALL
01789 414222



Ground Floor

Approx. 42.0 sq. metres (452.5 sq. feet)

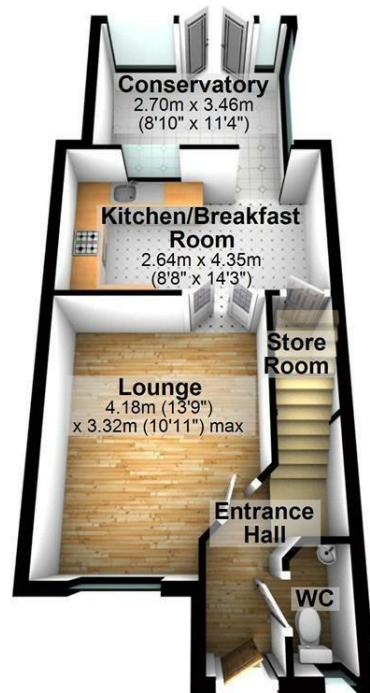

First Floor

Approx. 41.8 sq. metres (449.6 sq. feet)

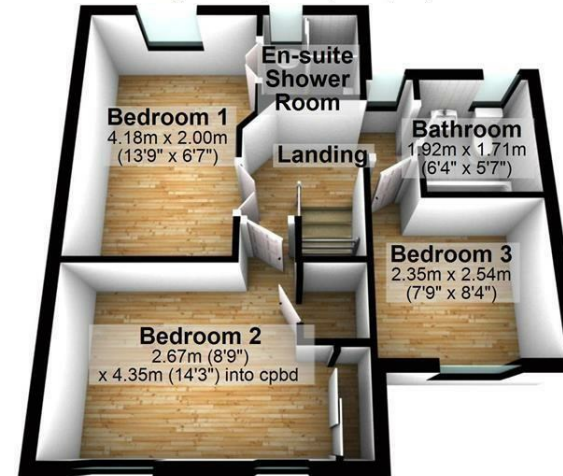

Total area: approx. 83.8 sq. metres (902.0 sq. feet)

**FOR MORE INFO AND
TO SEE OUR OTHER
LOVELY PROPERTIES
CHECK OUT OUR WEBSITE**

MOVEWITHEDWARDS.CO.UK

**HAVE YOU GOT
A PROPERTY
TO SELL?
WE'D LOVE TO
HAVE A CHAT
01789 414222**

**DID YOU KNOW WE ALSO
DO MORTGAGES.
FOR FREE ADVICE
SPEAK TO
ONE OF OUR
CONSULTANTS**

